

Site Address:
 Acre Cott,
 Chapel Rd,
 South Leigh, OX29 6UP
 KC1031 81059464-100201192



CPH Contact:
 Ramsey Office

Date of works:
 T.B.A

Drawn by: MB	Date drawn: 23/12/2020
-----------------	---------------------------

Drawing Requested By:
 Sophie Carter

KEY

-  Diversion Route
-  750 Road Cones
-  Sign
-  Temporary Pedestrian Crossing
-  Temporary Traffic Signals
-  Works Area
-  Safety Zone
-  Bus Stop To Be Suspended
-  Stop & Go
-  Van
-  No Parking Cone
-  Signalised Junction or Push Button Crossing
-  Pedestrian Barrier

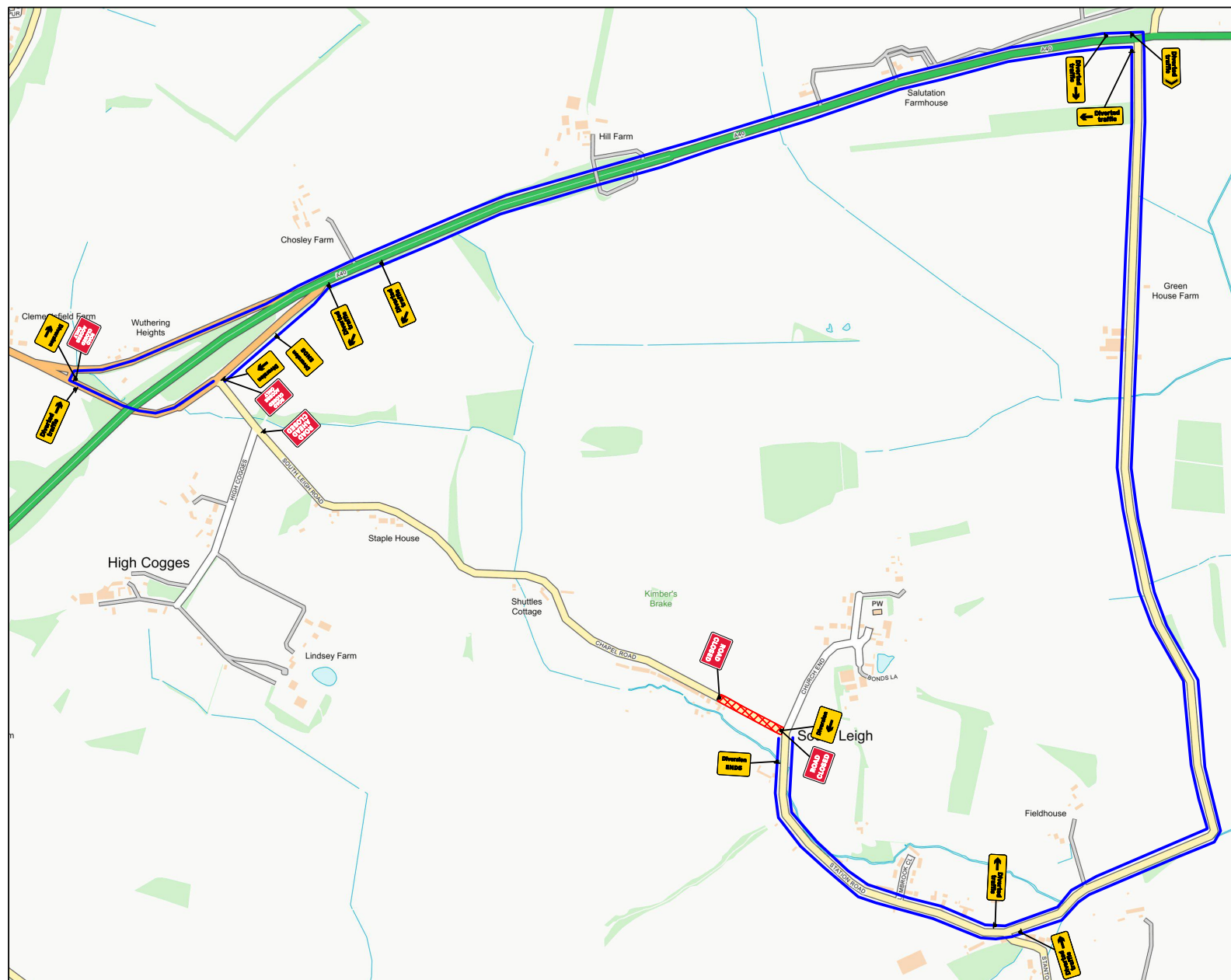

NOTES

- 1) All temporary traffic management shall be in accordance with Chapter 8 Part 1 Design (2009); Part 2 Operations (2009); Part 3 Update (2020).
- 2) All temporary traffic management shall be in accordance with the Traffic Signs Regulations and General Directions 2016.
- 3) All temporary traffic management shall conform to the Safety at Streetworks and Road Works ACOP 2013.
- 4) All temporary traffic management signs should be located 450mm minimum from the kerb face.
- 5) All temporary traffic management sign locations are indicative and are subject to on site approval from the supervisor.

ROAD CLOSURE / DIVERSION

SET-UP TO BE IN ACCORDANCE WITH THE NRSWA SAFETY AT STREET WORKS CODE



Clare House,
 Coppermill Ln,
 Harefield,
 Middlesex, UB9 6HZ
 Tel: 01895 823711
 Email:
 tmdrawings@theclancygroup.co.uk

Drawing Number:
 MB/9392